

RIGGING SCHEDULE

SET NO.	SET DESCRIPTION:	DISTANCE FROM DATUM TO CL. OF:			BATTEN		NO. OF LINES	SET CAPACITY	PURCHASE	MOTOR SPEED	WINCH LOCATION
		SET	HEAD BLOCK	DRIVE BLOCK	LENGTH	TYPE					
1	ELECTRIC #1	-10'-10"	2'-9"	2'-9"	60'-0"	DOUBLE	7	2000#	MOTORIZED	20 FPM	S.R.
2	TEASER	-8'-4"	---	---	EXISTING	SINGLE	9	---	DEAD HUNG	-	-
3	PROS. CURTAIN	-7'-5"	---	---	---	---	9	---	DEAD HUNG	-	-
4	ELECTRIC #2	-4'-4"	7'-4"	7'-4"	60'-0"	DOUBLE	7	2000#	MOTORIZED	20 FPM	S.R.
5	BORDER #1	2'-8"	3'-0"	---	94'-0"	SINGLE	9	1500#	COUNTERWEIGHT	-	-
6	ELECTRIC #3	3'-8"	3'-10"	3'-10"	70'-0"	DOUBLE	7	2000#	MOTORIZED	20 FPM	S.R.
7	TRAVELER #1	4'-8"	5'-0"	---	94'-0"	SINGLE	9	1500#	COUNTERWEIGHT	-	-
8	UTILITY	5'-4"	5'-8"	---	94'-0"	SINGLE	9	1500#	COUNTERWEIGHT	-	-
9	UTILITY	6'-0"	6'-4"	---	94'-0"	SINGLE	9	1500#	COUNTERWEIGHT	-	-
10	UTILITY	6'-8"	7'-0"	---	94'-0"	SINGLE	9	1500#	COUNTERWEIGHT	-	-
11	TRAVELER #2	8'-0"	8'-4"	---	94'-0"	SINGLE	9	1500#	COUNTERWEIGHT	-	-
12	ELECTRIC #4	9'-6"	9'-4"	9'-4"	70'-0"	DOUBLE	7	2000#	MOTORIZED	20 FPM	S.R.
13	UTILITY	11'-4"	11'-8"	---	94'-0"	SINGLE	9	1500#	COUNTERWEIGHT	-	-
14	BORDER #2	12'-0"	12'-4"	---	94'-0"	SINGLE	9	1500#	COUNTERWEIGHT	-	-
15	UTILITY	12'-8"	13'-0"	---	94'-0"	SINGLE	9	1500#	COUNTERWEIGHT	-	-
16	UTILITY	13'-4"	13'-8"	---	94'-0"	SINGLE	9	1500#	COUNTERWEIGHT	-	-
17	ELECTRIC #5	15'-6"	15'-4"	15'-4"	70'-0"	DOUBLE	7	2000#	MOTORIZED	20 FPM	S.R.
18	UTILITY	17'-4"	17'-8"	---	94'-0"	SINGLE	9	1500#	COUNTERWEIGHT	-	-
19	UTILITY	18'-0"	18'-4"	---	94'-0"	SINGLE	9	1500#	COUNTERWEIGHT	-	-
20	UTILITY	18'-8"	19'-0"	---	94'-0"	SINGLE	9	1500#	COUNTERWEIGHT	-	-
21	REAR CURTAIN	19'-4"	19'-8"	---	94'-0"	SINGLE	9	1500#	COUNTERWEIGHT	-	-
22	UTILITY	20'-0"	20'-4"	---	94'-0"	SINGLE	9	1500#	COUNTERWEIGHT	-	-
23	MOTORIZED UTILITY	20'-8"	20'-6"	20'-6"	70'-0"	SINGLE	7	2000#	MOTORIZED	20 FPM	S.R.
24	SCREEN	21'-8"	---	---	-	-	-	---	DEAD HUNG	-	-

DRAPERY SCHEDULE

SET DESCRIPTION:	FINISHED CURTAIN SIZE	MATERIAL	ADDED FULLNESS	COLOR	TRACK MODEL & LENGTH	NOTES
TEASER	90'-0"W x 5'-0"H	25 OZ. VELOUR	50%	CHERRY	---	3
PROSCENIUM CURTAIN	(2) 48'-0"W x 30'-0"H	25 OZ. VELOUR	50%	CHERRY	(2)H&H # 400 x 50'-0"	3, 4
BORDER	(2) 90'-0"W x 12'-0"H	25 OZ. VELOUR	50%	BLACK	---	3
SIDE LEGS	(4) 12'-0"W x 30'-0"H	25 OZ. VELOUR	50%	BLACK	---	3
TRAVELERS	(4) 44'-0"W x 30'-0"H	25 OZ. VELOUR	50%	BLACK	(4)H&H # 400 x 45'-0"	1, 2, 3
REAR TRAVELER	(2) X'-0"W x X'-0"H	25 OZ. VELOUR	50%	BLACK	(2)H&H # 400 x 50'-0"	1, 2, 3

NOTES:

1. PROVIDE TRACK COMPLETE WITH CORD OPERATION, AND FLOOR PULLEY AT STAGE LEFT
2. 3'-0" TRACK AND CURTAIN OVERLAP AT CENTERLINE.
3. REFER TO SPECIFICATIONS FOR CURTAIN CONSTRUCTION DETAILS.
4. CURTAQIN MACHINE TO TRAVEL FRONT CURTAIN

UNLESS OTHERWISE NOTED ON DRAWING ALL TOLERANCES TO BE AS FOLLOWS
 FRACTIONAL SIZES ±1/64
 DECIMAL SIZES ±.005
 ANGLES ±1/4"
 BREAK ALL SHARP EDGES

Texas Scenic Co.
 5423 Jackwood Drive
 San Antonio, Texas 78238

TRINITY UNIVERSITY - LAURIE AUDITORIUM
 SAN ANTONIO, TX

RIGGING & DRAPERY SCHEDULE

CHECKED BY:	DATE OF LAST REVISION:	BY:	-
SCALE:	DWG. & FILE NAME:	96103-01	
SIZE: B	NTS		

DRAWN BY: M.D.D.

ISSUED: 04/29/10

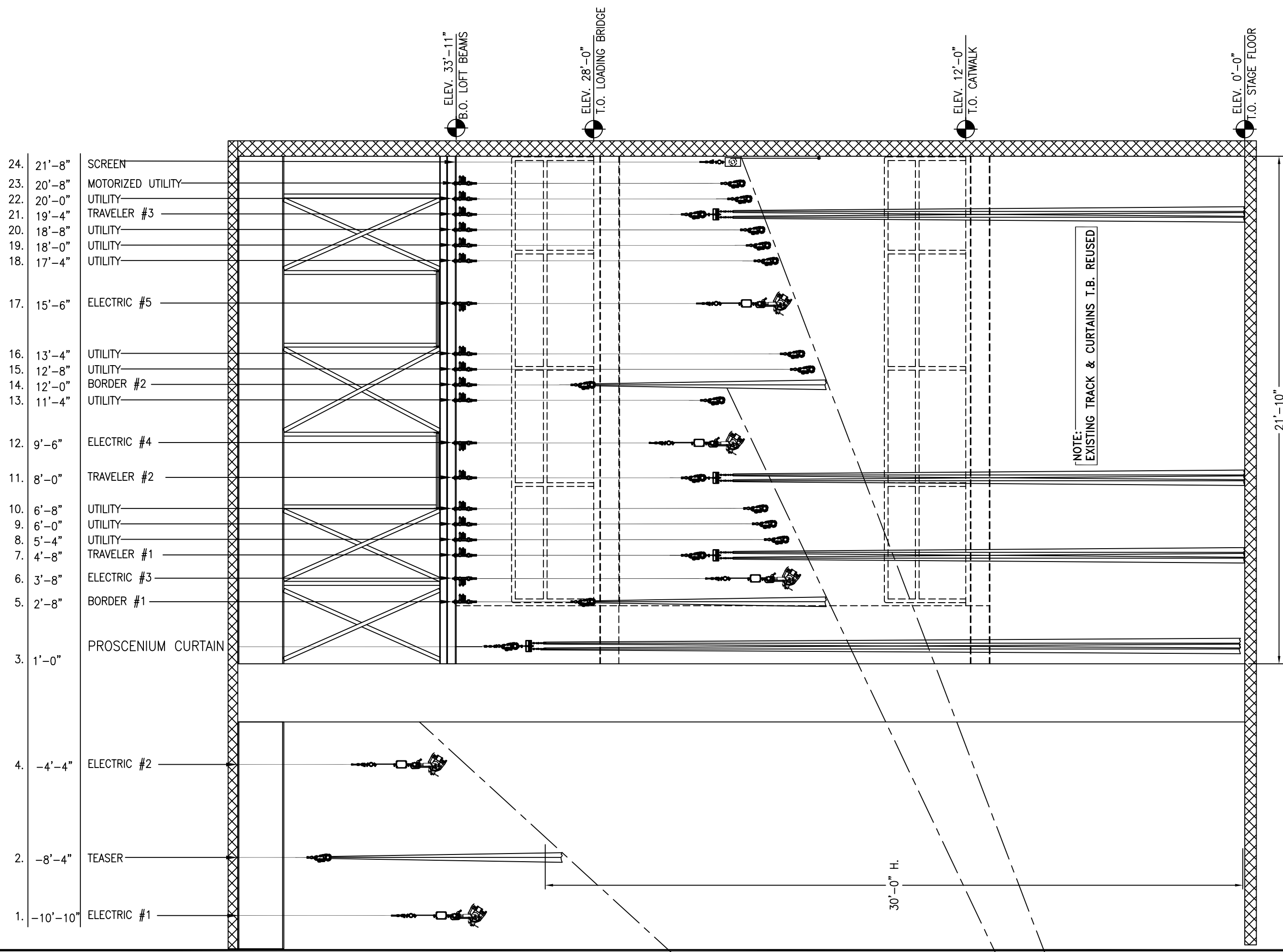

SECTION OF STAGE

TRINITY UNIVERSITY - LAURIE AUDITORIUM
 SAN ANTONIO, TX
 SECTION OF STAGE

DRAWN BY: D.Z.
 ISSUED: 05/20/10

SIZE	CHECKED BY:	REV:	DATE OF LAST REVISION:	BY:
B				
SCALE:	DWG. & FILE NAME: 96103-10			
1/4"=1'-0"				

Texas Scenic Co.
 5423 Jackwood Drive
 San Antonio, Texas 78238

UNLESS OTHERWISE NOTED ON
 DRAWING ALL TOLERANCES
 TO BE AS FOLLOWS
 FRACTIONAL SIZES ±1/64
 DECIMAL SIZES ±.005
 ANGLES ±1/4"
 BREAK ALL SHARP EDGES